

ANGLE STOP VALVE

Specification Sheet

1/4 Turn CPVC Angle Stop Valve

Feature:

- ✓ Forged Lead Free Brass Body
- ✓ Chrome plated and rough brass
- ✓ CPVC connection referred to ASTM-D2846 CTS (Copper Tube Size) CPVC
- ✓ Precision machined brass ball provides smooth operation and long-lasting durability
- ✓ Two high performance O-rings provide high temperature and corrosion resistant
- ✓ 100% leak tested
- ✓ Window box package

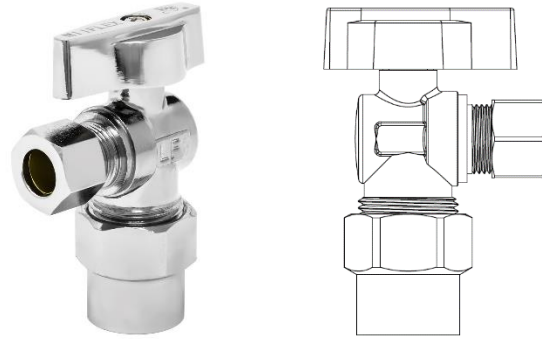

Part number	Description
4AP1238	1/2" CPVC x 3/8"OD Compression

Working Pressure & Temperature:

- 125 psi Maximum
- Temperature 40°F to 180°F

Dimensions				
Model	H1	H2	L1	L2
4AP1238	1.81	1.12	2.68	1.16

*Unit in Inch

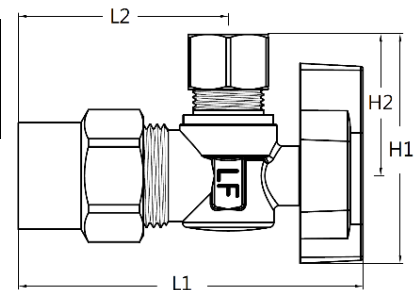

Approvals:

IAPMO NSF/ANSI-61 NSF/ANSI-372
ASME-A112.18.1



Part Name	Material
1 Screw	Stainless Steel
2 Handle	Zinc
3 O-ring	NBR
4 Stem	Lead Free Brass
5 Body	Lead Free Brass
6 Seal	NBR
7 Adapter	CPVC
8 Compression Nut	Brass
9 Ball Seat	PTFE
10 Ball	Lead Free Brass
11 O-ring	NBR
12 Adapter	Lead Free Brass
13 Sleeve	Copper Alloy
14 Compression Nut	Brass

