

4-Way Dual Outlet Angle Stop Valve

Feature:

- ✓ Forged Lead Free Brass Body
- ✓ Chrome plated and rough brass
- ✓ Precision machined brass ball provides smooth operation and long lasting durability
- ✓ Two high performance O-rings provide high temperature and corrosion resistant.
- ✓ 100% leak tested
- ✓ Window box package



Working Pressure & Temperature:

- 125 psi Maximum
- Temperature 40°F to 180°F

Approvals:

IAPMO NSF/ANSI-61 NSF/ANSI-372
ASME A112.18.1



Part number	Description
4AD3838	1/2 Nom. Compression x 3/8" OD Compression x 3/8" OD Compression
4AD3814	1/2 Nom. Compression x 3/8" OD Compression x 1/4" OD Compression

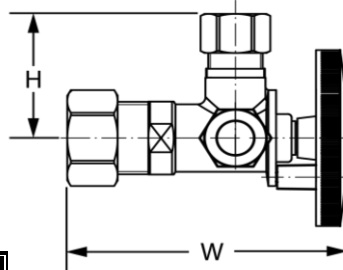

Dimensions		
Model	H	W
4AD3838	1.32	2.89
4AD3814	1.32	2.89

*Unit in inch

Part Name	Material
1 Compression Nut	Brass
2 Sleeve	Copper Alloy
3 Body	Lead Free Brass
4 Ball	Lead Free Brass
5 O-ring	NBR
6 Steel Ball	Stainless Steel
7 Spring	Stainless Steel
8 Hex Screw	Stainless Steel
9 Handle	Zinc
10 Screw	Stainless Steel
11 Ball Seat	PTFE
12 Adapter	Lead Free Brass
13 Sleeve	Copper Alloy
14 Compression Nut	Brass

